

**STATE OF COLORADO
COUNTY OF GILPIN
CITY OF BLACK HAWK**

COUNCIL BILL NUMBER: CB9

ORDINANCE NUMBER: 2020-9

TITLE: A BILL FOR AN ORDINANCE ZONING CERTAIN PROPERTY WITHIN THE CITY OF BLACK HAWK TO COMMERCIAL/BUSINESS SERVICES (C/BS) ZONING DISTRICT AND A PLANNED UNIT DEVELOPMENT (PUD) OVERLAY KNOWN AS THE LAKE GULCH WHISKEY RESORT PLANNED UNIT DEVELOPMENT, AND AMENDING THE CITY'S ZONING MAP TO CONFORM THEREWITH

BE IT ORDAINED BY THE CITY COUNCIL OF THE CITY OF BLACK HAWK, GILPIN COUNTY:

Section 1. Findings of Fact.

a. On February 12, 2020, the City Council approved a Resolution determining that certain annexation petitions submitted in a series for the real property described in attached **Exhibit A** (collectively, the "Real Property"), substantially complies with the requirements of C.R.S. § 31-12-107(1)(a) and set a public hearing for March 25, 2020, on the eligibility of the Real Property to be annexed into the City as provided by state law.

b. The City thereafter instituted the procedure for the initial zoning of the Real Property.

c. An application was submitted for initially zoning the Real Property to Commercial/Business Services (C/BS) with a Planned Unit Development (PUD) overlay district, pursuant to the City of Black Hawk Zoning Ordinance.

d. Public notice has been given of such zoning by one publication in a newspaper of general circulation within the City and the official newspaper of the City at least fifteen (15) days before the public hearing of such amendment.

e. Notice of such proposed hearing was posted on the Real Property for fifteen (15) consecutive days prior to said hearing.

f. A need exists for zoning the Real Property pursuant to Section 16-361 of the City of Black Hawk Zoning Ordinance as follows:

i. A need does exist for the zoning, and the PUD will implement the objectives of the City of Black Hawk Zoning Ordinance;

ii. The proposal for rezoning conforms with and is not inconsistent with the Comprehensive Plan;

iii. Additional growth opportunities and placemaking in the City of Black Hawk have changed and the proposal warrants new uses on the property;

iv. Adequate circulation exists in the area to support the initial zoning, and infrastructure will be constructed and extended to accommodate full build-out of the proposed project; and

v. Any additional cost for municipal-related services resulting from the proposal will not be incurred by the City, and are addressed in the Annexation Agreement to be approved concurrently herewith.

g. A need further exists for zoning the Real Property pursuant to Section 16-135 of the City of Black Hawk Zoning Ordinance in that the proposed Lake Gulch Whiskey Resort Planned Unit Development provides flexibility and will result in higher quality development based on the application of the purposes set forth in Section 16-135.

Section 2. The Real Property is hereby initially zoned to Commercial/Business Services (C/BS) with a Planned Unit Development (PUD) overlay district known as the Lake Gulch Whiskey Resort Planned Unit Development as provided in the Lake Gulch Whiskey Resort Planned Unit Development Standards and Plan, which is attached hereto as **Exhibit B**, and incorporated by this reference.

Section 3. The Zoning Ordinance and Zoning Map are hereby amended to conform with the zoning changes.

Section 4. Safety Clause. The City Council hereby finds, determines, and declares that this Ordinance is promulgated under the general police power of the City of Black Hawk, that it is promulgated for the health, safety, and welfare of the public, and that this Ordinance is necessary for the preservation of health and safety and for the protection of public convenience and welfare. The City Council further determines that the Ordinance bears a rational relation to the proper legislative object sought to be attained.

Section 5. Severability. If any clause, sentence, paragraph, or part of this Ordinance or the application thereof to any person or circumstances shall for any reason be adjudged by a court of competent jurisdiction invalid, such judgment shall not affect application to other persons or circumstances.

Section 6. Effective Date. The City Clerk is directed to post the Ordinance as required by the Charter. This Ordinance shall become effective upon posting by the City Clerk

READ, PASSED AND ORDERED POSTED this 25th day of March, 2020.

David D. Spellman, Mayor

ATTEST:

Melissa A. Greiner, CMC, City Clerk



Exhibit A

Lake Gulch Whiskey Resort Annexation No. 1

Legal Description

A parcel of land located in Sections 17 & 18, Township 3 South, Range 72 West of the 6th Principal Meridian, County of Gilpin, State of Colorado, being more particularly described as follows:

Commencing at the East $\frac{1}{4}$ corner of Section 13, T3S, R73W, being a US BLM standard brass cap, stamped "T3S R73W R72W $\frac{1}{4}$ S13 1980" from whence the northeast corner of said Section 13, being a US BLM standard brass cap, stamped "T3S R73W R72W CC S12 S13 1980", bears N $00^{\circ}14'12''$ E, a distance of 2,639.74 feet, said line forming the Basis of Bearing for this description; thence N $69^{\circ}30'48''$ E a distance of 3,617.79 feet to the point of intersection of line 3-4 of the Clay County Lode, US Mineral Survey No. 360 with line 4-1 of the Williams Crossing Lode, US Mineral Survey No. 15824 being the Point of Beginning.

Thence S $47^{\circ}53'33''$ E along said line 4-1 of said Williams Lode a distance of 296.23 feet to the point of intersection with line 3-2 of the Blow Out Lode, US Mineral Survey No. 18776;

thence N $19^{\circ}46'26''$ E along said line 3-2 of said Blow Out Lode a distance of 361.74 feet to the point of intersection with the east-west centerline of the NE $\frac{1}{4}$ of said Section 18 and the City of Black Hawk Patented Boundary;

thence N $89^{\circ}32'31''$ E along said east-west centerline of the NE $\frac{1}{4}$ and City of Black Hawk Patented Boundary a distance of 208.47 feet to the point of intersection with line 1-2 of the Great Britian Lode, US Mineral Survey No. 18776;

thence S $29^{\circ}18'00''$ W along said line 1-2 of said Great Britian Lode a distance of 353.67 feet to corner No. 2 of said Great Britian Lode;

thence S $46^{\circ}17'00''$ W along line 2-3 of said Great Britian Lode a distance of 131.10 feet to the point of intersection with line 4-1 of said Williams Crossing Lode;

thence S $47^{\circ}53'33''$ E along said line 4-1 of said Williams Crossing Lode a distance of 149.95 feet to the point of intersection with line 6-7 of said Great Britian Lode;

thence N $46^{\circ}22'45''$ E along said line 6-7 of said Great Britian Lode a distance of 142.56 feet to corner No. 7 of said Great Britian Lode;

thence N $29^{\circ}19'49''$ E along line 7-8 of said Great Britian Lode a distance of 461.80 feet to the point of intersection with said east-west centerline of the NE $\frac{1}{4}$ of said Section 18 and the City of Black Hawk Patented Boundary;

thence N $89^{\circ}32'31''$ E along said east-west centerline of the NE $\frac{1}{4}$ and City of Black Hawk Patented Boundary a distance of 474.24 feet to the point of intersection with line 16-15 of the Gold Tunnel No. 21 Lode, US Mineral Survey No. 4589;

thence S $43^{\circ}56'47''$ W along said line 16-15 of the Gold Tunnel No. 21 Lode a distance of 81.81 feet to corner No. 15 of the said Gold Tunnel No. 21 Lode;

thence S $46^{\circ}21'54''$ E along line 15-14 of the said Gold Tunnel No. 21 Lode, a distance of 150.01 feet to corner no. 14 of the said Gold Tunnel No. 21 Lode;

thence N $43^{\circ}56'15''$ E along line 14-13 of the said Gold Tunnel No. 21 Lode, a distance of 227.88 feet to the point of intersection with the east-west centerline of the NE $\frac{1}{4}$ of said Section 18 and the City of Black Hawk Patented Boundary;

thence N $89^{\circ}32'31''$ E along said east-west centerline of the NE $\frac{1}{4}$ and City of Black Hawk Patented Boundary a distance of 1040.34 feet to the N $1/16$ th corner of Sections 17 and 18;

thence N $87^{\circ}26'32''$ E along the east-west centerline of the NW $\frac{1}{4}$ of said Section 17 a distance of 165.11 feet to the point of intersection with line 3-2 of said East Williams Lode, US Mineral Survey No. 588;

thence S $47^{\circ}19'59''$ W along said line 3-2 of the East Williams Lode a distance of 204.89 feet to

corner No. 2 of said East Williams Lode;

thence S 42° 44' 49" E along line 2-1 of said East Williams Lode a distance of 152.37 feet to corner No. 1 of said East Williams Lode;

thence N 47° 20' 23" E along line 1-4 of said East Williams Lode a distance of 385.62 feet to the point of intersection with said east-west centerline of the NW ¼ of said Section 17 and the City of Black Hawk Patented Boundary;

thence N 87° 26' 32" E along said east-west centerline of the NW ¼ of said Section 17 and City of Black Hawk Patented Boundary a distance of 906.14 feet to the NW 1/16th corner of said Section 17;

thence N 01° 02' 29" W along the north-south centerline of said NW ¼ of said Section 17 and along the City of Black Hawk Patented Boundary a distance of 164.47 feet to the point of intersection with line 1-2 of the Mary Miller Lode, US Mineral Survey No. 969;

thence N 44° 28' 35" E along said line 1-2 of said Mary Miller Lode a distance of 60.92 feet to the point of intersection with said City of Black Hawk Patented Boundary;

thence N 88° 00' 45" E along said City of Black Hawk Patented Boundary a distance of 96.85 feet;

thence N 00° 18' 42" W along said City of Black Hawk Patented Boundary a distance of 91.93 feet to the point of intersection with line 6-5 of the Morgan Placer US Mineral Survey No. 226;

thence S 42° 19' 52" E along said line 6-5 of said Morgan Placer a distance of 92.75 feet to corner No. 5 of said Morgan Placer;

thence S 41° 03' 33" E along Colorado Department of Transportation deed recorded at Reception No. 141956 Gilpin County Records a distance of 12.42 feet to a CDOT 3 ¼ " aluminum cap;

thence S 49° 47' 21" E continuing along said Reception No. 141956 a distance of 43.07 feet to the point of intersection with line 3-4 of said Mary Miller Lode;

thence S 44° 27' 10" W along said line 3-4 of

said Mary Miller Lode a distance of 340.78 feet to the north-south centerline of said NW ¼ of said Section 17;

thence S 42° 07' 27" W a distance of 980.96 feet to corner No. 3 of the Little Mattie Lode, US Mineral Survey No. 970;

thence N 45° 33' 27" W along line 3-2 of said Little Mattie Lode a distance of 149.96 feet to corner No. 2 of said Little Mattie Lode;

thence S 44° 28' 40" W along line 2-1 of said Little Mattie Lode a distance of 1499.34 feet to corner No. 1 of said Little Mattie Lode;

thence S 45° 17' 32" E along line 1-4 of said Little Mattie Lode a distance of 149.75 feet to corner No. 4 of said Little Mattie Lode;

thence S 27° 33' 11" E a distance of 938.48 feet to the S 1/16th corner of Sections 17 and 18;

thence N 88° 20' 50" W a distance of 663.62 feet to a point on the easterly edge of Lake Gulch Road, County Road 6;

thence along said easterly edge of said Lake Gulch Road the following 32 courses:

1. N 04° 13' 02" W a distance of 31.99 feet;
2. N 07° 44' 55" W a distance of 32.64 feet;
3. N 18° 09' 05" W a distance of 33.14 feet;
4. N 38° 37' 56" W a distance of 34.32 feet;
5. N 53° 47' 50" W a distance of 29.23 feet;
6. N 75° 08' 14" W a distance of 35.56 feet;
7. N 85° 37' 54" W a distance of 30.90 feet;
8. S 89° 52' 43" W a distance of 27.50 feet;
9. N 87° 06' 51" W a distance of 30.91 feet;
10. N 85° 25' 50" W a distance of 33.32 feet;
11. N 83° 57' 02" W a distance of 32.67 feet;
12. N 82° 55' 20" W a distance of 27.68 feet;
13. N 84° 02' 37" W a distance of 25.81 feet;
14. N 85° 10' 50" W a distance of 29.44 feet;
15. N 85° 57' 08" W a distance of 28.99 feet;
16. N 85° 47' 52" W a distance of 28.17 feet;

17. N 81° 25' 50" W a distance of 28.60 feet;
 18. N 76° 41' 49" W a distance of 29.15 feet;
 19. N 73° 08' 35" W a distance of 28.55 feet;
 20. N 70° 53' 21" W a distance of 28.11 feet;
 21. N 69° 40' 34" W a distance of 29.60 feet;
 22. N 69° 16' 06" W a distance of 30.58 feet;
 23. N 69° 23' 51" W a distance of 31.51 feet;
 24. N 69° 00' 03" W a distance of 30.04 feet;
 25. N 67° 48' 40" W a distance of 31.55 feet;
 26. N 68° 24' 20" W a distance of 27.25 feet;
 27. N 62° 37' 03" W a distance of 29.46 feet;
 28. N 58° 52' 53" W a distance of 25.03 feet;
 29. N 54° 58' 57" W a distance of 28.04 feet;
 30. N 57° 56' 49" W a distance of 30.20 feet;
 31. N 61° 34' 17" W a distance of 32.80 feet;
 32. N 66° 40' 06" W a distance of 25.01 feet to a point on line 1-4 of Washingtons Day Lode, US Mineral Survey 11885;
- thence along said line 1-4 N 39° 23' 17" E a distance of 633.47 feet to corner No. 4 of said Washingtons Day Lode;
- thence along line 4-3 of said Washingtons Day Lode N 45° 12' 18" W a distance of 150.58 feet to corner No. 3 of said Washingtons Day Lode;
- thence N 40° 53' 21" W a distance of 1,096.94 feet;
- thence N 47° 01' 18" E a distance of 320.86 feet;
- thence N 42° 58' 23" W a distance of 169.95 feet;
- thence S 47° 00' 48" W a distance of 314.68 feet;
- thence N 40° 53' 21" W a distance of 710.26 feet to the Point of Beginning,
- EXCEPT the Denver Lode, US Mineral Survey 745, total parcel containing 100.5 acres gross, 95.35 acres net more or less.

Lake Gulch Whiskey Resort Annexation No.2

Legal Description

A parcel of land located in Section 18, Township 3 South, Range 72 West of the 6th Principal Meridian, County of Gilpin, State of Colorado, being more particularly described as follows:

Commencing at the East ¼ corner of Section 13, T3S, R73W, being a US BLM standard brass cap, stamped "T3S R73W R72W ¼ S13 1980" from whence the northeast corner of said Section 13, being a US BLM standard brass cap, stamped "T3S R73W R72W CC S12 S13 1980", bears N 00° 14' 12" E, a distance of 2,639.74 feet, said line forming the Basis of Bearing for this description; thence N 69° 30' 48" E a distance of 3,617.79 feet to the point of intersection of line 3-4 of the Clay County Lode, US Mineral Survey No. 360 with line 4-1 of the Williams Crossing Lode, US Mineral Survey No. 15824 being the Point of Beginning.

Thence S 40° 53' 21" E along the City of Black Hawk Boundary a distance of 710.26 feet;

thence N 47° 00' 48" E a distance of 314.68 feet;

thence S 42° 58' 23" E a distance of 169.95 feet;

thence S 47° 01' 18" W a distance of 320.86 feet;

thence S 40° 53' 21" E a distance of 1096.94 feet to corner No. 3 of the Washingtons Day Lode, US Mineral Survey 11885;

thence along line 3-2 of said Washingtons Day Lode S 39° 23' 18" W a distance of 664.25 feet to a point on the easterly edge of Lake Gulch Road, County Road 6;

thence along said easterly edge the following 42 courses:

1. N 48° 28' 12" W a distance of 24.56 feet;
2. N 50° 23' 24" W a distance of 26.25 feet;
3. N 53° 50' 43" W a distance of 25.59 feet;
4. N 53° 43' 00" W a distance of 33.90 feet;
5. N 52° 37' 45" W a distance of 28.19 feet;
6. N 51° 12' 12" W a distance of 30.55 feet;
7. N 49° 32' 52" W a distance of 30.52 feet;

8. N 48° 21' 34" W a distance of 28.91 feet;
9. N 47° 37' 34" W a distance of 28.24 feet;
10. N 45° 09' 35" W a distance of 27.49 feet;
11. N 43° 31' 15" W a distance of 28.13 feet;
12. N 42° 12' 45" W a distance of 27.54 feet;
13. N 38° 01' 46" W a distance of 25.88 feet;
14. N 34° 08' 31" W a distance of 30.46 feet;
15. N 37° 44' 53" W a distance of 28.83 feet;
16. N 42° 43' 23" W a distance of 30.25 feet;
17. N 43° 58' 04" W a distance of 27.96 feet;
18. N 45° 20' 47" W a distance of 27.74 feet;
19. N 49° 06' 25" W a distance of 26.55 feet;
20. N 51° 35' 16" W a distance of 26.06 feet;
21. N 59° 58' 24" W a distance of 29.16 feet;
22. N 61° 25' 24" W a distance of 33.52 feet;
23. N 61° 44' 13" W a distance of 33.59 feet;
24. N 59° 21' 59" W a distance of 26.42 feet;
25. N 49° 29' 24" W a distance of 26.70 feet;
26. N 37° 52' 45" W a distance of 31.32 feet;
27. N 30° 56' 40" W a distance of 24.48 feet;
28. N 29° 24' 22" W a distance of 27.32 feet;
29. N 33° 48' 48" W a distance of 27.44 feet;
30. N 38° 52' 14" W a distance of 38.09 feet;
31. N 46° 02' 34" W a distance of 25.97 feet;
32. N 47° 57' 34" W a distance of 35.15 feet;
33. N 47° 25' 27" W a distance of 31.08 feet;
34. N 43° 51' 36" W a distance of 31.28 feet;
35. N 39° 40' 26" W a distance of 30.10 feet;
36. N 41° 30' 58" W a distance of 32.61 feet;
37. N 41° 29' 04" W a distance of 32.31 feet;
38. N 41° 52' 51" W a distance of 35.65 feet;
39. N 42° 17' 50" W a distance of 25.71 feet;
40. N 44° 56' 55" W a distance of 26.51 feet;

41. N 47° 16' 09" W a distance of 32.58 feet;

42. N 44° 25' 34" W a distance of 5.81 feet to the point of intersection with line 4-3 of the Tariff Lode, US Mineral Survey No. 966;

thence N 47° 01' 18" E along said line 4-3 of said Tariff Lode a distance of 1068.76 feet to corner No. 3 of said Tariff Lode;

thence N 42° 58' 23" W along line 3-2 of said Tariff Lode a distance of 149.95 feet to corner No. 2 of said Tariff lode;

thence S 47° 00' 48" W along line 2-1 of said Tariff Lode a distance of 367.57 feet to the point of intersection with line 2-3 of the Williams Lode, US Mineral Survey No. 15824;

thence N 47° 53' 26" W along said line 2-3 of said Williams Lode a distance of 660.81 feet to the point of intersection with line 6-5 of the East Clay County Lode, US Mineral Survey No. 18776;

thence S 17° 31' 51" W along said line 6-5 of said East Clay County Lode a distance of 88.60 feet to the point of intersection with line 3-2 of the Clay County Lode, US Mineral Survey No. 329A;

thence N 51° 26' 36" W along said line 3-2 of said Clay County Lode a distance of 26.56 feet to corner No. 4 of said Clay County Lode, US Mineral Survey No. 360;

thence N 52° 11' 23" W along line 4-1 of said Clay County Lode, US Mineral Survey No. 360 a distance of 114.49 feet to corner No. 2 of said Clay County Lode, US Mineral Survey No. 329A;

thence S 37° 28' 00" W along line 2-1 of said Clay County Lode, US Mineral Survey No. 329A a distance of 547.96 feet to the point of intersection with line 4-1 of the Clay County Lode, US Mineral Survey No. 329B;

thence N 54° 01' 59" W along said line 4-1 of the Clay County Lode, US Mineral Survey No. 329B a distance of 109.70 feet to corner No. 1 of said Clay County Lode, US Mineral Survey No. 329B;

thence S 50° 08' 44" W along line 1-2 of said

Clay County Lode, US Mineral Survey No. 329B a distance of 172.25 feet to the point of intersection with the easterly edge of Lake Gulch Road;

thence along said easterly edge of Lake Gulch Road the following 12 courses:

1. N 52° 05' 43" W a distance of 4.07 feet;
2. N 50° 32' 17" W a distance of 30.12 feet;
3. N 48° 45' 27" W a distance of 31.84 feet;
4. N 48° 19' 15" W a distance of 29.52 feet;
5. N 44° 59' 11" W a distance of 32.08 feet;
6. N 38° 27' 56" W a distance of 34.04 feet;
7. N 34° 37' 33" W a distance of 32.85 feet;
8. N 32° 21' 41" W a distance of 28.92 feet;
9. N 30° 53' 34" W a distance of 33.92 feet;
10. N 29° 02' 31" W a distance of 37.67 feet;
11. N 28° 29' 34" W a distance of 25.05 feet;
12. N 28° 12' 54" W a distance of 1.33 feet to the point of intersection with line 1-2 of the Caledonia Lode, US Mineral Survey No. MS 519;

thence N 49° 29' 47" E along said line 1-2 of said Caledonia Lode a distance of 724.79 feet to the point of intersection with line 6-5 of the Golden Gad Lode, US Mineral Survey No. 13048;

thence N 31° 43' 33" W along said line 6-5 of said Golden Gad Lode a distance of 50.45 feet to the point of intersection with the east-west centerline of said NW ¼ of said Section 18 and the City of Black Hawk Patented Boundary; thence S 89° 38' 09" E along said east-west centerline of the NW ¼ and along the City of Black Hawk Patented Boundary a distance of 258.49 feet to the N 1/16th corner on the north-south centerline of said Section 18; thence N 89° 32' 31" E along the east-west centerline of the NE ¼ of said Section 18 and along the City of Black Hawk Patented Boundary a distance of 246.17 feet to the point of intersection with line 3-4 of the Clay County Lode, US Mineral Survey No. 360; thence S 27° 50' 26" W along said line 3-4 of

said Clay County Lode a distance of 157.91 feet to the point of intersection with line 4-1 of the Williams Crossing Lode, US Mineral Survey No. 15824, the Point of Beginning, containing 29.21 acres more or less.

Lake Gulch Whiskey Resort Annexation No.3

Legal Description

A parcel of land located in Section 18, Township 3 South, Range 72 West of the 6th Principal Meridian, County of Gilpin, State of Colorado, being more particularly described as follows:

Commencing at the East ¼ corner of Section 13, T3S, R73W, being a US BLM standard brass cap, stamped "T3S R73W R72W ¼ S13 1980" from whence the northeast corner of said Section 13, being a US BLM standard brass cap, stamped "T3S R73W R72W CC S12 S13 1980", bears N 00° 14' 12" E, a distance of 2,639.74 feet, said line forming the Basis of Bearing for this description; thence N 00° 14' 12" E along the east line of the NE ¼ of said Section 13 a distance of 876.53 feet to the point of intersection with the northerly and easterly edge of Lake Gulch Road, County Road 6. Thence along said northerly and easterly edge of Lake Gulch Road the following 66 courses:

1. S 84° 44' 44" E a distance of 13.72 feet;
2. S 85° 15' 25" E a distance of 35.41 feet;
3. S 84° 42' 28" E a distance of 33.69 feet;
4. S 85° 28' 26" E a distance of 32.03 feet;
5. S 86° 21' 19" E a distance of 31.14 feet;
6. S 87° 13' 04" E a distance of 29.82 feet;
7. S 88° 23' 53" E a distance of 29.18 feet;
8. S 88° 24' 09" E a distance of 34.66 feet;
9. S 88° 22' 11" E a distance of 25.20 feet;
10. S 88° 22' 02" E a distance of 36.97 feet;
11. S 89° 43' 04" E a distance of 35.02 feet;
12. N 88° 16' 44" E a distance of 36.59 feet;
13. N 87° 31' 19" E a distance of 26.26 feet;

14. N 85° 29' 19" E a distance of 27.58 feet;
15. N 84° 48' 46" E a distance of 29.08 feet;
16. N 84° 07' 35" E a distance of 28.85 feet;
17. N 82° 03' 23" E a distance of 28.00 feet;
18. N 78° 58' 54" E a distance of 26.68 feet;
19. N 76° 54' 40" E a distance of 25.60 feet;
20. N 77° 08' 36" E a distance of 25.55 feet;
21. N 78° 10' 02" E a distance of 25.48 feet;
22. N 78° 39' 54" E a distance of 37.64 feet;
23. N 79° 54' 14" E a distance of 26.32 feet;
24. N 80° 28' 29" E a distance of 26.01 feet;
25. N 80° 13' 10" E a distance of 25.64 feet;
26. N 82° 00' 47" E a distance of 25.87 feet;
27. N 83° 11' 19" E a distance of 25.72 feet;
28. N 81° 54' 30" E a distance of 25.51 feet;
29. N 80° 36' 50" E a distance of 36.86 feet;
30. N 77° 53' 04" E a distance of 25.17 feet;
31. N 76° 30' 21" E a distance of 26.42 feet;
32. N 74° 45' 56" E a distance of 26.43 feet;
33. N 73° 10' 29" E a distance of 27.05 feet;
34. N 71° 02' 53" E a distance of 28.52 feet;
35. N 69° 29' 32" E a distance of 29.17 feet;
36. N 68° 02' 26" E a distance of 28.70 feet;
37. N 68° 11' 55" E a distance of 28.34 feet;
38. N 68° 11' 21" E a distance of 28.58 feet;
39. N 70° 17' 29" E a distance of 27.99 feet;
40. N 72° 23' 23" E a distance of 26.42 feet;
41. N 72° 28' 10" E a distance of 26.21 feet;
42. N 68° 41' 24" E a distance of 27.08 feet;
43. N 71° 51' 48" E a distance of 27.85 feet;
44. N 74° 45' 31" E a distance of 27.76 feet;
45. N 75° 42' 50" E a distance of 28.93 feet;
46. N 77° 13' 39" E a distance of 29.52 feet;

47. N 78° 51' 11" E a distance of 28.58 feet;
48. N 78° 32' 38" E a distance of 26.85 feet;
49. N 76° 41' 51" E a distance of 25.03 feet;
50. N 79° 17' 59" E a distance of 29.12 feet;
51. N 78° 11' 27" E a distance of 5.49 feet;
52. N 77° 38' 35" E a distance of 34.79 feet;
53. N 77° 18' 33" E a distance of 34.86 feet;
54. N 76° 11' 24" E a distance of 34.36 feet;
55. N 76° 19' 36" E a distance of 34.21 feet;
56. N 75° 55' 53" E a distance of 32.92 feet;
57. N 75° 45' 56" E a distance of 33.64 feet;
58. N 77° 56' 07" E a distance of 54.90 feet;
59. N 79° 21' 17" E a distance of 32.59 feet;
60. N 79° 51' 30" E a distance of 30.19 feet;
61. N 81° 04' 54" E a distance of 30.69 feet;
62. N 82° 42' 42" E a distance of 26.71 feet;
63. N 85° 59' 16" E a distance of 29.83 feet;
64. N 87° 30' 36" E a distance of 25.59 feet;
65. N 89° 45' 47" E a distance of 26.85 feet;

66. S 89° 47' 40" E a distance of 21.27 feet to the point of intersection with line 3-2 of the St. Anthony Lode, US Mineral Survey No. 19174;

thence N 39° 31' 27" E along said line 3-2 of said St. Anthony Lode a distance of 246.50 feet to the point of intersection with line 1-6 of the Susan-Mary Lode, US Mineral Survey No. 694;

thence S 19° 06' 00" E along said line 1-6 of said Susan-Mary Lode a distance of 35.27 feet to corner No. 6 of said Susan-Mary Lode;

thence N 70° 54' 00" E along line 6-5 of said Susan-Mary Lode a distance of 224.97 feet to the point of intersection with the east-west centerline of the NW 1/4 of said Section 18, the City of Black Hawk Patented Boundary;

thence S 89° 38' 09" E along said east-west centerline and City of Black Hawk Patented Boundary a distance of 553.67 feet to the point of intersection with line 4-3 of the Golden Gad

Lode, US Mineral Survey No. 13048;

thence S 49° 45' 10" W along said line 4-3 of said Golden Gad Lode a distance of 340.06 feet to corner No. 3 of said Golden Gad Lode;

thence S 63° 17' 40" W along line 3-2 of said Golden Gad Lode a distance of 259.61 feet to the point of intersection with the easterly edge of Lake Gulch Road;

thence along said easterly edge of Lake Gulch Road the following 178 courses:

79. S 47° 36' 27" E a distance of 20.45 feet;
80. S 37° 01' 46" E a distance of 33.69 feet;
81. S 31° 20' 23" E a distance of 35.62 feet;
82. S 29° 21' 33" E a distance of 35.80 feet;
83. S 28° 33' 24" E a distance of 35.14 feet;
84. S 28° 15' 54" E a distance of 26.48 feet;
85. S 28° 12' 54" E a distance of 25.97 feet;
86. S 28° 29' 34" E a distance of 25.05 feet;
87. S 29° 02' 31" E a distance of 37.67 feet;
88. S 30° 53' 34" E a distance of 33.92 feet;
89. S 32° 21' 41" E a distance of 28.92 feet;
90. S 34° 37' 33" E a distance of 32.85 feet;
91. S 38° 27' 56" E a distance of 34.04 feet;
92. S 44° 59' 11" E a distance of 32.08 feet;
93. S 48° 19' 15" E a distance of 29.52 feet;
94. S 48° 45' 27" E a distance of 31.84 feet;
95. S 50° 32' 17" E a distance of 30.12 feet;
96. S 52° 05' 43" E a distance of 32.15 feet;
97. S 51° 09' 16" E a distance of 29.84 feet;
98. S 51° 16' 35" E a distance of 28.26 feet;
99. S 53° 32' 16" E a distance of 26.81 feet;
100. S 54° 36' 48" E a distance of 27.25 feet;
101. S 54° 32' 13" E a distance of 32.80 feet;
102. S 57° 04' 54" E a distance of 26.24 feet;
103. S 58° 48' 15" E a distance of 27.12 feet;

104. S 58° 36' 20" E a distance of 29.13 feet;
105. S 57° 16' 49" E a distance of 30.45 feet;
106. S 57° 52' 07" E a distance of 29.57 feet;
107. S 57° 47' 48" E a distance of 29.54 feet;
108. S 58° 32' 09" E a distance of 30.64 feet;
109. S 58° 55' 55" E a distance of 31.93 feet;
110. S 60° 47' 03" E a distance of 32.05 feet;
111. S 64° 12' 09" E a distance of 30.05 feet;
112. S 66° 59' 32" E a distance of 31.36 feet;
113. S 64° 57' 54" E a distance of 31.74 feet;
114. S 66° 27' 41" E a distance of 30.74 feet;
115. S 62° 36' 41" E a distance of 31.24 feet;
116. S 56° 45' 33" E a distance of 32.71 feet;
117. S 52° 10' 05" E a distance of 34.02 feet;
118. S 47° 33' 12" E a distance of 35.06 feet;
119. S 46° 14' 32" E a distance of 33.54 feet;
120. S 46° 05' 49" E a distance of 31.95 feet;
121. S 47° 24' 34" E a distance of 33.28 feet;
122. S 46° 33' 23" E a distance of 34.15 feet;
123. S 45° 20' 14" E a distance of 34.73 feet;
124. S 45° 05' 49" E a distance of 33.04 feet;
125. S 45° 18' 29" E a distance of 32.28 feet;
126. S 44° 25' 34" E a distance of 31.87 feet;
127. S 47° 16' 09" E a distance of 32.58 feet;
128. S 44° 56' 55" E a distance of 26.51 feet;
129. S 42° 17' 50" E a distance of 25.71 feet;
130. S 41° 52' 51" E a distance of 35.65 feet;
131. S 41° 29' 04" E a distance of 32.31 feet;
132. S 41° 30' 58" E a distance of 32.61 feet;
133. S 39° 40' 26" E a distance of 30.10 feet;
134. S 43° 51' 36" E a distance of 31.28 feet;
135. S 47° 25' 27" E a distance of 31.08 feet;
136. S 47° 57' 34" E a distance of 35.15 feet;

137. S 46° 02' 34" E a distance of 25.97 feet;
138. S 38° 52' 14" E a distance of 38.09 feet;
139. S 33° 48' 48" E a distance of 27.44 feet;
140. S 29° 24' 22" E a distance of 27.32 feet;
141. S 30° 56' 40" E a distance of 24.48 feet;
142. S 37° 52' 45" E a distance of 31.32 feet;
143. S 49° 29' 24" E a distance of 26.70 feet;
144. S 59° 21' 59" E a distance of 26.42 feet;
145. S 61° 44' 13" E a distance of 33.59 feet;
146. S 61° 25' 24" E a distance of 33.52 feet;
147. S 59° 58' 24" E a distance of 29.16 feet;
148. S 51° 35' 16" E a distance of 26.06 feet;
149. S 49° 06' 25" E a distance of 26.55 feet;
150. S 45° 20' 47" E a distance of 27.74 feet;
151. S 43° 58' 04" E a distance of 27.96 feet;
152. S 42° 43' 23" E a distance of 30.25 feet;
153. S 37° 44' 53" E a distance of 28.83 feet;
154. S 34° 08' 31" E a distance of 30.46 feet;
155. S 38° 01' 46" E a distance of 25.88 feet;
156. S 42° 12' 45" E a distance of 27.54 feet;
157. S 43° 31' 15" E a distance of 28.13 feet;
158. S 45° 09' 35" E a distance of 27.49 feet;
159. S 47° 37' 34" E a distance of 28.24 feet;
160. S 48° 21' 34" E a distance of 28.91 feet;
161. S 49° 32' 52" E a distance of 30.52 feet;
162. S 51° 12' 12" E a distance of 30.55 feet;
163. S 52° 37' 45" E a distance of 28.19 feet;
164. S 53° 43' 00" E a distance of 33.90 feet;
165. S 53° 50' 43" E a distance of 25.59 feet;
166. S 50° 23' 24" E a distance of 26.25 feet;
167. S 48° 28' 12" E a distance of 27.86 feet;
168. S 48° 55' 48" E a distance of 29.88 feet;
169. S 51° 44' 53" E a distance of 28.55 feet;

170. S 56° 10' 53" E a distance of 31.14 feet;
171. S 62° 17' 04" E a distance of 31.05 feet;
172. S 66° 41' 03" E a distance of 25.85 feet;
173. S 66° 40' 06" E a distance of 27.06 feet;
174. S 61° 34' 17" E a distance of 32.80 feet;
175. S 57° 56' 49" E a distance of 30.20 feet;
176. S 54° 58' 57" E a distance of 28.04 feet;
177. S 58° 52' 53" E a distance of 25.03 feet;
178. S 62° 37' 03" E a distance of 29.46 feet;
179. S 68° 24' 20" E a distance of 27.25 feet;
180. S 67° 48' 40" E a distance of 31.55 feet;
181. S 69° 00' 03" E a distance of 30.04 feet;
182. S 69° 23' 51" E a distance of 31.51 feet;
183. S 69° 16' 06" E a distance of 30.58 feet;
184. S 69° 40' 34" E a distance of 29.60 feet;
185. S 70° 53' 21" E a distance of 28.11 feet;
186. S 73° 08' 35" E a distance of 28.55 feet;
187. S 76° 41' 49" E a distance of 29.15 feet;
188. S 81° 25' 50" E a distance of 28.60 feet;
189. S 85° 47' 52" E a distance of 28.17 feet;
190. S 85° 57' 08" E a distance of 28.99 feet;
191. S 85° 10' 50" E a distance of 29.44 feet;
192. S 84° 02' 37" E a distance of 25.81 feet;
193. S 82° 55' 20" E a distance of 27.68 feet;
194. S 83° 57' 02" E a distance of 32.67 feet;
195. S 85° 25' 50" E a distance of 33.32 feet;
196. S 87° 06' 51" E a distance of 30.91 feet;
197. N 89° 52' 43" E a distance of 27.50 feet;
198. S 85° 37' 54" E a distance of 30.90 feet;
199. S 75° 08' 14" E a distance of 35.56 feet;
200. S 53° 47' 50" E a distance of 29.23 feet;
201. S 38° 37' 56" E a distance of 34.32 feet;
202. S 18° 09' 05" E a distance of 33.14 feet;

203. S 07° 44' 55" E a distance of 32.64 feet;
 204. S 04° 13' 02" E a distance of 31.99 feet;
 205. S 00° 41' 58" W a distance of 31.57 feet;
 206. S 01° 13' 29" W a distance of 32.44 feet;
 207. S 00° 03' 20" E a distance of 32.16 feet;
 208. S 02° 47' 46" W a distance of 28.30 feet;
 209. S 06° 12' 17" W a distance of 38.26 feet;
 210. S 16° 17' 42" W a distance of 37.16 feet;
 211. S 24° 29' 21" W a distance of 29.34 feet;
 212. S 28° 41' 22" W a distance of 45.06 feet;
 213. S 34° 24' 43" W a distance of 30.28 feet;
 214. S 40° 01' 56" W a distance of 30.05 feet;
 215. S 43° 22' 45" W a distance of 38.41 feet;
 216. S 41° 40' 02" W a distance of 34.91 feet;
 217. S 37° 13' 45" W a distance of 32.47 feet;
 218. S 31° 34' 31" W a distance of 32.66 feet;
 219. S 26° 02' 44" W a distance of 35.71 feet;
 220. S 24° 24' 12" W a distance of 32.11 feet;
 221. S 20° 02' 45" W a distance of 28.30 feet;
 222. S 19° 00' 54" W a distance of 35.03 feet;
 223. S 15° 53' 59" W a distance of 32.80 feet;
 224. S 13° 56' 52" W a distance of 28.35 feet;
 225. S 13° 41' 03" W a distance of 27.80 feet;
 226. S 14° 06' 12" W a distance of 47.10 feet;
 227. S 11° 45' 46" W a distance of 29.86 feet;
 228. S 13° 18' 52" W a distance of 15.92 feet;
 229. S 10° 22' 47" W a distance of 30.16 feet;
 230. S 09° 29' 42" W a distance of 30.12 feet;
 231. S 11° 50' 43" W a distance of 31.40 feet;
 232. S 11° 03' 12" W a distance of 31.62 feet;
 233. S 10° 04' 56" W a distance of 25.34 feet;
 234. S 11° 08' 36" W a distance of 19.58 feet;
 235. S 33° 47' 37" E a distance of 7.58 feet;

236. S 32° 05' 32" E a distance of 27.59 feet;
 237. S 44° 08' 01" E a distance of 29.13 feet;
 238. S 52° 04' 36" E a distance of 27.04 feet;
 239. S 54° 37' 49" E a distance of 25.73 feet;
 240. S 54° 46' 58" E a distance of 26.38 feet;
 241. S 58° 03' 45" E a distance of 30.82 feet;
 242. S 59° 18' 04" E a distance of 25.17 feet;
 243. S 63° 19' 05" E a distance of 29.27 feet;
 244. S 60° 16' 48" E a distance of 30.28 feet;
 245. S 61° 39' 09" E a distance of 33.01 feet;
 246. S 61° 28' 38" E a distance of 33.37 feet;
 247. S 55° 46' 17" E a distance of 29.95 feet;
 248. S 56° 17' 05" E a distance of 38.86 feet;
 249. S 51° 45' 51" E a distance of 57.67 feet;
 250. S 48° 44' 08" E a distance of 91.48 feet;
 251. S 45° 53' 24" E a distance of 48.20 feet;
 252. S 43° 37' 26" E a distance of 41.87 feet;
 253. S 45° 38' 04" E a distance of 24.91 feet;
 254. S 49° 36' 04" E a distance of 29.00 feet;
 255. S 53° 53' 44" E a distance of 30.11 feet;
 256. S 58° 27' 45" E a distance of 15.49 feet
 to the point of intersection with the south line of
 the SE ¼ of said Section 18;

thence N 89° 44' 17" W along said south line of
 said SE ¼ of said Section 18 a distance of 39.68
 feet to the point of intersection with the westerly
 and southerly edge of said Lake Gulch Road;

thence along said westerly and southerly edge of
 said Lake Gulch Road the following 259 courses:

1. N 53° 53' 44" W a distance of 14.21 feet;
2. N 49° 36' 04" W a distance of 30.59 feet;
3. N 45° 38' 04" W a distance of 26.06 feet;
4. N 43° 37' 26" W a distance of 41.82 feet;
5. N 45° 53' 24" W a distance of 47.21 feet;
6. N 48° 44' 08" W a distance of 90.36 feet;

7. N 51° 45' 51" W a distance of 56.22 feet;
8. N 56° 17' 05" W a distance of 38.09 feet;
9. N 55° 46' 17" W a distance of 28.96 feet;
10. N 61° 28' 38" W a distance of 32.24 feet;
11. N 61° 39' 09" W a distance of 33.24 feet;
12. N 60° 16' 48" W a distance of 29.96 feet;
13. N 63° 19' 05" W a distance of 29.46 feet;
14. N 59° 18' 04" W a distance of 26.18 feet;
15. N 58° 03' 45" W a distance of 31.69 feet;
16. N 54° 46' 58" W a distance of 27.04 feet;
17. N 54° 37' 49" W a distance of 26.25 feet;
18. N 52° 04' 36" W a distance of 29.05 feet;
19. N 44° 08' 01" W a distance of 32.98 feet;
20. N 32° 05' 32" W a distance of 29.58 feet;
21. N 33° 47' 37" W a distance of 16.35 feet;
22. N 11° 08' 36" E a distance of 28.47 feet;
23. N 10° 04' 56" E a distance of 25.32 feet;
24. N 11° 03' 12" E a distance of 31.96 feet;
25. N 11° 50' 43" E a distance of 31.10 feet;
26. N 09° 29' 42" E a distance of 29.84 feet;
27. N 10° 22' 47" E a distance of 30.89 feet;
28. N 13° 18' 52" E a distance of 16.19 feet;
29. N 11° 45' 46" E a distance of 30.01 feet;
30. N 14° 06' 12" E a distance of 47.47 feet;
31. N 13° 41' 03" E a distance of 27.77 feet;
32. N 13° 56' 52" E a distance of 28.78 feet;
33. N 15° 53' 59" E a distance of 33.77 feet;
34. N 19° 00' 54" E a distance of 35.82 feet;
35. N 20° 02' 45" E a distance of 29.34 feet;
36. N 24° 24' 12" E a distance of 33.26 feet;
37. N 26° 02' 44" E a distance of 37.09 feet;
38. N 31° 34' 31" E a distance of 34.81 feet;
39. N 37° 13' 45" E a distance of 34.41 feet;
40. N 41° 40' 02" E a distance of 36.10 feet;
41. N 43° 22' 45" E a distance of 38.09 feet;
42. N 40° 01' 56" E a distance of 28.32 feet;
43. N 34° 24' 43" E a distance of 28.10 feet;
44. N 28° 41' 22" E a distance of 43.15 feet;
45. N 24° 29' 21" E a distance of 26.96 feet;
46. N 16° 17' 42" E a distance of 33.64 feet;
47. N 06° 12' 17" E a distance of 35.66 feet;
48. N 02° 47' 46" E a distance of 27.09 feet;
49. N 00° 03' 20" W a distance of 31.86 feet;
50. N 01° 13' 29" E a distance of 32.59 feet;
51. N 00° 41' 58" E a distance of 30.52 feet;
52. N 04° 13' 02" W a distance of 30.37 feet;
53. N 07° 44' 55" W a distance of 29.96 feet;
54. N 18° 09' 05" W a distance of 27.17 feet;
55. N 38° 37' 56" W a distance of 27.41 feet;
56. N 53° 47' 50" W a distance of 22.16 feet;
57. N 75° 08' 14" W a distance of 29.40 feet;
58. N 85° 37' 54" W a distance of 28.02 feet;
59. S 89° 52' 43" W a distance of 27.21 feet;
60. N 87° 06' 51" W a distance of 31.81 feet;
61. N 85° 25' 50" W a distance of 33.93 feet;
62. N 83° 57' 02" W a distance of 33.15 feet;
63. N 82° 55' 20" W a distance of 27.67 feet;
64. N 84° 02' 37" W a distance of 25.38 feet;
65. N 85° 10' 50" W a distance of 29.07 feet;
66. N 85° 57' 08" W a distance of 28.87 feet;
67. N 85° 47' 52" W a distance of 29.04 feet;
68. N 81° 25' 50" W a distance of 30.35 feet;
69. N 76° 41' 49" W a distance of 30.74 feet;
70. N 73° 08' 35" W a distance of 29.67 feet;
71. N 70° 53' 21" W a distance of 28.78 feet;
72. N 69° 40' 34" W a distance of 29.91 feet;

73. N 69° 16' 06" W a distance of 30.63 feet;
74. N 69° 23' 51" W a distance of 31.56 feet;
75. N 69° 00' 03" W a distance of 30.35 feet;
76. N 67° 48' 40" W a distance of 31.66 feet;
77. N 68° 24' 20" W a distance of 28.25 feet;
78. N 62° 37' 03" W a distance of 31.29 feet;
79. N 58° 52' 53" W a distance of 26.50 feet;
80. N 54° 58' 57" W a distance of 28.22 feet;
81. N 57° 56' 49" W a distance of 28.94 feet;
82. N 61° 34' 17" W a distance of 31.12 feet;
83. N 66° 40' 06" W a distance of 26.08 feet;
84. N 66° 41' 03" W a distance of 26.69 feet;
85. N 62° 17' 04" W a distance of 33.06 feet;
86. N 56° 10' 53" W a distance of 33.17 feet;
87. N 51° 44' 53" W a distance of 29.94 feet;
88. N 48° 55' 48" W a distance of 30.51 feet;
89. N 48° 28' 12" W a distance of 27.58 feet;
90. N 50° 23' 24" W a distance of 25.21 feet;
91. N 53° 50' 43" W a distance of 24.95 feet;
92. N 53° 43' 00" W a distance of 34.13 feet;
93. N 52° 37' 45" W a distance of 28.67 feet;
94. N 51° 12' 12" W a distance of 31.14 feet;
95. N 49° 32' 52" W a distance of 31.07 feet;
96. N 48° 21' 34" W a distance of 29.28 feet;
97. N 47° 37' 34" W a distance of 28.86 feet;
98. N 45° 09' 35" W a distance of 28.28 feet;
99. N 43° 31' 15" W a distance of 28.69 feet;
100. N 42° 12' 45" W a distance of 28.59 feet;
101. N 38° 01' 46" W a distance of 27.43 feet;
102. N 34° 08' 31" W a distance of 30.52 feet;
103. N 37° 44' 53" W a distance of 27.18 feet;
104. N 42° 43' 23" W a distance of 29.05 feet;
105. N 43° 58' 04" W a distance of 27.46 feet;

106. N 45° 20' 47" W a distance of 26.75 feet;
107. N 49° 06' 25" W a distance of 25.35 feet;
108. N 51° 35' 16" W a distance of 23.97 feet;
109. N 59° 58' 24" W a distance of 27.27 feet;
110. N 61° 25' 24" W a distance of 33.19 feet;
111. N 61° 44' 13" W a distance of 33.99 feet;
112. N 59° 21' 59" W a distance of 28.78 feet;
113. N 49° 29' 24" W a distance of 30.84 feet;
114. N 37° 52' 45" W a distance of 34.89 feet;
115. N 30° 56' 40" W a distance of 26.10 feet;
116. N 29° 24' 22" W a distance of 26.77 feet;
117. N 33° 48' 48" W a distance of 25.62 feet;
118. N 38° 52' 14" W a distance of 35.74 feet;
119. N 46° 02' 34" W a distance of 24.23 feet;
120. N 47° 57' 34" W a distance of 34.89 feet;
121. N 47° 25' 27" W a distance of 31.87 feet;
122. N 43° 51' 36" W a distance of 32.77 feet;
123. N 39° 40' 26" W a distance of 30.55 feet;
124. N 41° 30' 58" W a distance of 32.25 feet;
125. N 41° 29' 04" W a distance of 32.24 feet;
126. N 41° 52' 51" W a distance of 35.49 feet;
127. N 42° 17' 50" W a distance of 25.12 feet;
128. N 44° 56' 55" W a distance of 25.56 feet;
129. N 47° 16' 09" W a distance of 32.68 feet;
130. N 44° 25' 34" W a distance of 32.24 feet;
131. N 45° 18' 29" W a distance of 32.15 feet;
132. N 45° 05' 49" W a distance of 33.03 feet;
133. N 45° 20' 14" W a distance of 34.45 feet;
134. N 46° 33' 23" W a distance of 33.75 feet;
135. N 47° 24' 34" W a distance of 33.36 feet;
136. N 46° 05' 49" W a distance of 32.17 feet;
137. N 46° 14' 32" W a distance of 33.26 feet;
138. N 47° 33' 12" W a distance of 33.92 feet;

139. N 52° 10' 05" W a distance of 32.26 feet;
140. N 56° 45' 33" W a distance of 30.70 feet;
141. N 62° 36' 41" W a distance of 29.38 feet;
142. N 66° 27' 41" W a distance of 30.28 feet;
143. N 64° 57' 54" W a distance of 31.64 feet;
144. N 66° 59' 32" W a distance of 31.51 feet;
145. N 64° 12' 09" W a distance of 31.24 feet;
146. N 60° 47' 03" W a distance of 33.06 feet;
147. N 58° 55' 55" W a distance of 32.37 feet;
148. N 58° 32' 09" W a distance of 30.86 feet;
149. N 57° 47' 48" W a distance of 29.66 feet;
150. N 57° 52' 07" W a distance of 29.67 feet;
151. N 57° 16' 49" W a distance of 30.31 feet;
152. N 58° 36' 20" W a distance of 28.84 feet;
153. N 58° 48' 15" W a distance of 27.42 feet;
154. N 57° 04' 54" W a distance of 27.06 feet;
155. N 54° 32' 13" W a distance of 33.27 feet;
156. N 54° 36' 48" W a distance of 27.44 feet;
157. N 53° 32' 16" W a distance of 27.45 feet;
158. N 51° 16' 35" W a distance of 28.72 feet;
159. N 51° 09' 16" W a distance of 29.69 feet;
160. N 52° 05' 43" W a distance of 32.27 feet;
161. N 50° 32' 17" W a distance of 30.76 feet;
162. N 48° 45' 27" W a distance of 32.27 feet;
163. N 48° 19' 15" W a distance of 30.25 feet;
164. N 44° 59' 11" W a distance of 33.97 feet;
165. N 38° 27' 56" W a distance of 36.03 feet;
166. N 34° 37' 33" W a distance of 34.03 feet;
167. N 32° 21' 41" W a distance of 29.64 feet;
168. N 30° 53' 34" W a distance of 34.55 feet;
169. N 29° 02' 31" W a distance of 38.14 feet;
170. N 28° 29' 34" W a distance of 25.20 feet;
171. N 28° 12' 54" W a distance of 26.03 feet;

172. N 28° 15' 54" W a distance of 26.41 feet;
173. N 28° 33' 24" W a distance of 34.93 feet;
174. N 29° 21' 33" W a distance of 35.27 feet;
175. N 31° 20' 23" W a distance of 34.15 feet;
176. N 37° 01' 46" W a distance of 30.56 feet;
177. N 47° 36' 27" W a distance of 27.50 feet;
178. N 55° 33' 38" W a distance of 30.91 feet;
179. N 61° 36' 30" W a distance of 25.13 feet;
180. N 63° 34' 32" W a distance of 26.32 feet;
181. N 64° 31' 22" W a distance of 25.12 feet;
182. N 67° 22' 05" W a distance of 26.00 feet;
183. N 69° 56' 57" W a distance of 31.66 feet;
184. N 71° 44' 22" W a distance of 26.36 feet;
185. N 73° 18' 40" W a distance of 30.03 feet;
186. N 77° 37' 44" W a distance of 25.62 feet;
187. N 82° 16' 38" W a distance of 26.04 feet;
188. N 88° 32' 40" W a distance of 28.15 feet;
189. S 89° 07' 00" W a distance of 25.28 feet;
190. S 87° 57' 44" W a distance of 28.75 feet;
191. S 89° 11' 41" W a distance of 28.08 feet;
192. S 89° 11' 13" W a distance of 25.02 feet;
193. N 89° 16' 33" W a distance of 25.73 feet;
194. N 89° 47' 40" W a distance of 29.71 feet;
195. S 89° 45' 47" W a distance of 26.33 feet;
196. S 87° 30' 36" W a distance of 24.87 feet;
197. S 85° 59' 16" W a distance of 28.91 feet;
198. S 82° 42' 42" W a distance of 25.77 feet;
199. S 81° 04' 54" W a distance of 30.14 feet;
200. S 79° 51' 30" W a distance of 29.85 feet;
201. S 79° 21' 17" W a distance of 32.22 feet;
202. S 77° 56' 07" W a distance of 54.21 feet;
203. S 75° 45' 56" W a distance of 33.26 feet;
204. S 75° 55' 53" W a distance of 33.03 feet;

205. S 76° 19' 36" W a distance of 34.26 feet;
 206. S 76° 11' 24" W a distance of 34.55 feet;
 207. S 77° 18' 33" W a distance of 35.14 feet;
 208. S 77° 38' 35" W a distance of 34.96 feet;
 209. S 78° 11' 27" W a distance of 5.81 feet;
 210. S 79° 17' 59" W a distance of 28.84 feet;
 211. S 76° 41' 51" W a distance of 24.88 feet;
 212. S 78° 32' 38" W a distance of 27.26 feet;
 213. S 78° 51' 11" W a distance of 28.33 feet;
 214. S 77° 13' 39" W a distance of 28.92 feet;
 215. S 75° 42' 50" W a distance of 28.46 feet;
 216. S 74° 45' 31" W a distance of 27.02 feet;
 217. S 71° 51' 48" W a distance of 26.69 feet;
 218. S 68° 41' 24" W a distance of 27.19 feet;
 219. S 72° 28' 10" W a distance of 26.92 feet;
 220. S 72° 23' 23" W a distance of 26.00 feet;
 221. S 70° 17' 29" W a distance of 27.18 feet;
 222. S 68° 11' 21" W a distance of 28.17 feet;
 223. S 68° 11' 55" W a distance of 28.31 feet;
 224. S 68° 02' 26" W a distance of 28.95 feet;
 225. S 69° 29' 32" W a distance of 29.75 feet;
 226. S 71° 02' 53" W a distance of 29.23 feet;
 227. S 73° 10' 29" W a distance of 27.76 feet;
 228. S 74° 45' 56" W a distance of 27.07 feet;
 229. S 76° 30' 21" W a distance of 27.01 feet;
 230. S 77° 53' 04" W a distance of 25.96 feet;
 231. S 80° 36' 50" W a distance of 37.64 feet;
 232. S 81° 54' 30" W a distance of 26.00 feet;
 233. S 83° 11' 19" W a distance of 25.74 feet;
 234. S 82° 00' 47" W a distance of 25.30 feet;
 235. S 80° 13' 10" W a distance of 25.35 feet;
 236. S 80° 28' 29" W a distance of 25.95 feet;
 237. S 79° 54' 14" W a distance of 25.97 feet;

238. S 78° 39' 54" W a distance of 37.31 feet;
 239. S 78° 10' 02" W a distance of 25.19 feet;
 240. S 77° 08' 36" W a distance of 25.31 feet;
 241. S 76° 54' 40" W a distance of 25.95 feet;
 242. S 78° 58' 54" W a distance of 27.66 feet;
 243. S 82° 03' 23" W a distance of 28.99 feet;
 244. S 84° 07' 35" W a distance of 29.37 feet;
 245. S 84° 48' 46" W a distance of 29.34 feet;
 246. S 85° 29' 19" W a distance of 28.10 feet;
 247. S 87° 31' 19" W a distance of 26.80 feet;
 248. S 88° 16' 44" W a distance of 37.12 feet;
 249. N 89° 43' 04" W a distance of 35.66 feet;
 250. N 88° 22' 02" W a distance of 37.23 feet;
 251. N 88° 22' 11" W a distance of 25.20 feet;
 252. N 88° 24' 09" W a distance of 34.65 feet;
 253. N 88° 23' 53" W a distance of 29.41 feet;
 254. N 87° 13' 04" W a distance of 30.21 feet;
 255. N 86° 21' 19" W a distance of 31.47 feet;
 256. N 85° 28' 26" W a distance of 32.34 feet;
 257. N 84° 42' 28" W a distance of 33.73 feet;
 258. N 85° 15' 25" W a distance of 35.41 feet;
 259. N 84° 44' 44" W a distance of 11.88 feet
 to the point of intersection with the east line of
 said NE ¼ of said Section 13;

thence N 00° 14' 12" E along said east line of
 said NE ¼ of said Section 13 a distance of 22.08
 feet to the Point of Beginning containing 8.03
 acres more or less.

Lake Gulch Whiskey Resort Annexation No.4

Legal Description

A parcel of land located in Section 18, Township
 3 South, Range 72 West of the 6th Principal
 Meridian, County of Gilpin, State of Colorado,
 being more particularly described as follows:

Commencing at the East $\frac{1}{4}$ corner of Section 13, T3S, R73W, being a US BLM standard brass cap, stamped "T3S R73W R72W $\frac{1}{4}$ S13 1980" from whence the northeast corner of said Section 13, being a US BLM standard brass cap, stamped "T3S R73W R72W CC S12 S13 1980", bears N $00^{\circ}14'12''$ E, a distance of 2,639.74 feet, said line forming the Basis of Bearing for this description; thence S $77^{\circ}17'58''$ E a distance of 5,336.50 feet to a point on the easterly edge of Lake Gulch Road, being the Point of Beginning.

Thence S $88^{\circ}20'50''$ E along the City of Black Hawk Boundary a distance of 663.62 feet to the S $1/16$ th corner of Sections 17 and 18;

thence S $00^{\circ}00'33''$ W along the east line of the SE $\frac{1}{4}$ of said Section 18 a distance of 1312.03 feet to the SE corner of said Section 18;

thence N $89^{\circ}44'17''$ W along the south line of the SE $\frac{1}{4}$ of said Section 18 a distance of 387.79 feet to a point on the easterly edge of Lake Gulch Road, County Road 6;

thence along said easterly edge of said Lake Gulch Road the following 32 courses:

1. N $58^{\circ}27'45''$ W a distance of 15.49 feet;
2. N $53^{\circ}53'44''$ W a distance of 30.11 feet;
3. N $49^{\circ}36'04''$ W a distance of 29.00 feet;
4. N $45^{\circ}38'04''$ W a distance of 24.91 feet;
5. N $43^{\circ}37'26''$ W a distance of 41.87 feet;
6. N $45^{\circ}53'24''$ W a distance of 48.20 feet;
7. N $48^{\circ}44'08''$ W a distance of 91.48 feet;
8. N $51^{\circ}45'51''$ W a distance of 57.67 feet;
9. N $56^{\circ}17'05''$ W a distance of 38.86 feet;
10. N $55^{\circ}46'17''$ W a distance of 29.95 feet;
11. N $61^{\circ}28'38''$ W a distance of 33.37 feet;
12. N $61^{\circ}39'09''$ W a distance of 33.01 feet;
13. N $60^{\circ}16'48''$ W a distance of 30.28 feet;
14. N $63^{\circ}19'05''$ W a distance of 29.27 feet;
15. N $59^{\circ}18'04''$ W a distance of 25.17 feet;
16. N $58^{\circ}03'45''$ W a distance of 30.82 feet;
17. N $54^{\circ}46'58''$ W a distance of 26.38 feet;
18. N $54^{\circ}37'49''$ W a distance of 25.73 feet;
19. N $52^{\circ}04'36''$ W a distance of 27.04 feet;
20. N $44^{\circ}08'01''$ W a distance of 29.13 feet;
21. N $32^{\circ}05'32''$ W a distance of 27.59 feet;
22. N $33^{\circ}47'37''$ W a distance of 7.58 feet;
23. N $11^{\circ}08'36''$ E a distance of 19.58 feet;
24. N $10^{\circ}04'56''$ E a distance of 25.34 feet;
25. N $11^{\circ}03'12''$ E a distance of 31.62 feet;
26. N $11^{\circ}50'43''$ E a distance of 31.40 feet;
27. N $09^{\circ}29'42''$ E a distance of 30.12 feet;
28. N $10^{\circ}22'47''$ E a distance of 30.16 feet;
29. N $13^{\circ}18'52''$ E a distance of 15.92 feet;
30. N $11^{\circ}45'46''$ E a distance of 29.86 feet;
31. N $14^{\circ}06'12''$ E a distance of 47.10 feet;
32. N $13^{\circ}41'03''$ E a distance of 24.47 feet to the point of intersection with line 2-3 of the Rickard Lode, US Mineral Survey No. 16283;

thence N $67^{\circ}02'38''$ E along said line 2-3 of said Rickard Lode a distance of 945.51 feet to corner No. 3 of said Rickard Lode;

thence N $23^{\circ}02'09''$ W along line 3-4 of said Rickard Lode a distance of 150.08 feet to corner No. 4 of said Rickard Lode;

thence S $67^{\circ}01'09''$ W along line 4-1 of said Rickard Lode a distance of 153.49 feet to the point of intersection with line 3-4 of the Olivia Lode, US Mineral Survey No. 13916;

thence S $29^{\circ}39'14''$ E along said line 3-4 a distance of 131.02 feet to corner No. 4 of said Olivia Lode;

thence S $60^{\circ}16'49''$ W along line 4-1 of said Olivia Lode a distance of 150.24 feet to corner No. 1 of said Olivia Lode;

thence N $29^{\circ}41'13''$ W along line 1-2 of said Olivia Lode a distance of 148.78 to the point of intersection with said line 4-1 of said Rickard Lode;

thence S 67° 01' 09" W along said line 4-1 of said Rickard Lode a distance of 497.85 feet to the point of intersection with the easterly line of said Lake Gulch Road;

thence along said easterly edge of said Lake Gulch Road the following 14 courses:

1. N 31° 34' 31" E a distance of 20.73 feet;
2. N 37° 13' 45" E a distance of 32.47 feet;
3. N 41° 40' 02" E a distance of 34.91 feet;
4. N 43° 22' 45" E a distance of 38.41 feet;
5. N 40° 01' 56" E a distance of 30.05 feet;
6. N 34° 24' 43" E a distance of 30.28 feet;
7. N 28° 41' 22" E a distance of 45.06 feet;
8. N 24° 29' 21" E a distance of 29.34 feet;
9. N 16° 17' 42" E a distance of 37.16 feet;
10. N 06° 12' 17" E a distance of 38.26 feet;
11. N 02° 47' 46" E a distance of 28.30 feet;
12. N 00° 03' 20" W a distance of 32.16 feet;
13. N 01° 13' 29" E a distance of 32.44 feet;
14. N 00° 41' 58" E a distance of 31.57 feet to the Point of Beginning, containing 20.72 acres more or less.

Lake Gulch Whiskey Resort Annexation No.5

Legal Description

A parcel of land located in Section 18, Township 3 South, Range 72 West of the 6th Principal Meridian, County of Gilpin, State of Colorado, being more particularly described as follows:

Commencing at the East ¼ corner of Section 13, T3S, R73W, being a US BLM standard brass cap, stamped "T3S R73W R72W ¼ S13 1980" from whence the northeast corner of said Section 13, being a US BLM standard brass cap, stamped "T3S R73W R72W CC S12 S13 1980", bears N 00° 14' 12" E, a distance of 2,639.74 feet, said line forming the Basis of Bearing for this description; thence N 37° 49' 49" E a distance of 1,154.79 feet to the intersection of line 3-4 of the Annex

Lode, US Mineral Survey No. 7799 with the easterly and northerly edge of Lake Gulch Road, County Road 6 being the Point of Beginning.

Thence N 61° 53' 31" E along said line 3-4 of said Annex Lode a distance of 1064.95 feet to the point of intersection with the east-west centerline of the NW ¼ of said Section 18 and the City of Black Hawk Patented Boundary;

thence S 89° 38' 09" E along said east-west centerline of said NW ¼ and City of Black Hawk Patented Boundary a distance of 227.43 feet to the point of intersection with line 1-4 of the St. Anthony Lode, US Mineral Survey No. 19174;

thence S 39° 30' 42" W along said line 1-4 of said St. Anthony Lode a distance of 328.85 feet to the point of intersection with said easterly and northerly edge of Lake Gulch Road;

thence along said easterly and northerly edge of Lake Gulch Road the following 8 courses:

1. S 79° 21' 17" W a distance of 10.12 feet;
2. S 77° 56' 07" W a distance of 54.90 feet;
3. S 75° 45' 56" W a distance of 33.64 feet;
4. S 75° 55' 53" W a distance of 32.92 feet;
5. S 76° 19' 36" W a distance of 34.21 feet;
6. S 76° 11' 24" W a distance of 34.36 feet;
7. S 77° 18' 33" W a distance of 34.86 feet;
8. S 77° 38' 35" W a distance of 27.75 feet to the point of intersection with line 1-2 of the Elizabeth Lode, US Mineral Survey No. 15894;

thence N 39° 23' 46" E along said line 1-2 of said Elizabeth Lode a distance of 249.88 feet to the point of intersection with line 3-2 of the Black Diamond Lode, US Mineral Survey No. 17634;

thence S 63° 58' 12" W along said line 3-2 of said Black Diamond Lode a distance of 827.46 feet to the point of intersection with said easterly and northerly edge of said Lake Gulch Road;

thence along said easterly and northerly edge of said Lake Gulch Road the following 5 courses:

1. S 80° 36' 50" W a distance of 18.54 feet;
2. S 81° 54' 30" W a distance of 25.51 feet;

3. S 83° 11' 19" W a distance of 25.72 feet;
4. S 82° 00' 47" W a distance of 25.87 feet;
5. S 80° 13' 10" W a distance of 22.34 feet to the Point of Beginning containing 2.58 acres more or less.

Lake Gulch Whiskey Resort Annexation No.6

Legal Description

A parcel of land located in Section 18, Township 3 South, Range 72 West of the 6th Principal Meridian, County of Gilpin, State of Colorado, being more particularly described as follows:

Commencing at the East ¼ corner of Section 13, T3S, R73W, being a US BLM standard brass cap, stamped "T3S R73W R72W ¼ S13 1980" from whence the northeast corner of said Section 13, being a US BLM standard brass cap, stamped "T3S R73W R72W CC S12 S13 1980", bears N 00°14'12" E, a distance of 2,639.74 feet, said line forming the Basis of Bearing for this description; thence N 20° 56' 43" E a distance of 997.85 feet to the point of intersection of line 3-4 of the Dale Lode, US Mineral Survey No. 13338 with line 2-1 of the Notaway Extension Lode, US Mineral Survey No. 9722 being the Point of Beginning.

thence N 24° 10' 55" E along said line 2-1 of said Notaway Extension Lode a distance of 105.93 feet to the point of intersection with line 1-5 of the Gulch Lode, US Mineral Survey No. 12784;

thence N 36° 25' 58" E along said line 1-5 of said Gulch Lode a distance of 382.53 feet to corner No. 5 of said Gulch Lode;

thence N 52° 39' 02" W along line 5-4 of said Gulch Lode a distance of 83.36 feet to the point of intersection with said Line 2-1 of said Notaway Extension Lode;

thence N 24° 10' 55" E along said Line 2-1 of said Notaway Extension Lode a distance of 36.99 feet to the point of intersection with the east-west centerline of the NW ¼ of said Section 18 and the City of Black Hawk Patented Boundary;

thence S 89° 38' 09" E along said east-west centerline and City of Black Hawk Patented Boundary a distance of 756.52 feet to the point

of intersection with line 1-2 of the Annex Lode, US Mineral Survey No. 7799;

thence S 61° 53' 31" W along said line 1-2 of said Annex Lode a distance of 776.77 feet to the point of intersection with line 7-6 of said Dale Lode, US Mineral Survey No. 13338;

thence N 39° 23' 00" E along said line 7-6 of said Dale Lode a distance of 409.81 feet to corner No. 6 of said Dale Lode;

thence N 50° 28' 19" W along line 6-5 of said Dale Lode a distance of 74.00 feet to corner No. 5 of said Dale Lode;

thence N 89° 24' 17" W along line 5-4 of said Dale Lode a distance of 97.24 feet to corner No. 4 of said Dale Lode;

thence S 39° 23' 43" W along line 4-3 of said Dale Lode a distance of 624.77 feet to the Point of Beginning containing 2.35 acres more or less.

Lake Gulch Whiskey Resort Annexation No.7

Legal Description

A parcel of land located in Sections 17 and 18, Township 3 South, Range 72 West of the 6th Principal Meridian, County of Gilpin, State of Colorado, being more particularly described as follows:

Commencing at the East ¼ corner of Section 13, T3S, R73W, being a US BLM standard brass cap, stamped "T3S R73W R72W ¼ S13 1980" from whence the northeast corner of said Section 13, being a US BLM standard brass cap, stamped "T3S R73W R72W CC S12 S13 1980", bears N 00°14'12" E, a distance of 2,639.74 feet, said line forming the Basis of Bearing for this description; thence S 77° 17' 58" E a distance of 5,336.50 feet to a point on the easterly edge of Lake Gulch Road;

thence S 88° 20' 50" E along the City of Black Hawk Boundary a distance of 663.62 feet to the S 1/16th corner of Sections 17 and 18 being the Point of Beginning.

Thence N 27° 33' 11" W along the City of Black Hawk Boundary a distance of 938.48 feet to corner No. 4 of the Little Mattie Lode, US

Mineral Survey No. 970;

thence N 44° 29' 09" E along line 4-3 of said Little Mattie Lode a distance of 1500.03 feet to corner No. 3 of said Little Mattie Lode;

thence N 42° 07' 27" E along the City of Black Hawk Boundary a distance of 980.96 feet to the north-south centerline of the NW ¼ of said Section 17;

thence S 01° 03' 00" E along said north-south centerline of said NW ¼ of said Section 17 a distance of 1273.98 feet to the W 1/16th corner on the east-west centerline of said NW ¼ of Section 17;

thence S 00° 21' 55" E along said north-south centerline of said NW ¼ of said Section 17 a distance of 111.85 feet to the point of intersection with line 1-2 of the Mascot Lode, US Mineral Survey No. 845;

thence S 55° 22' 15" W along said line 1-2 of said Mascot Lode a distance of 100.62 feet to corner No. 2 of said Mascot Lode;

thence S 34° 54' 36" E along line 2-3 of said Mascot Lode a distance of 146.65 feet to the point of intersection with the north-south centerline of the SW ¼ of said Section 17;

thence S 00° 21' 55" E along said north-south centerline of said SW ¼ of said Section 17 a distance of 1034.62 feet to the SW 1/16th corner of said Section 17;

thence S 88° 35' 30" W along the east-west centerline of the SW ¼ of said Section 17 a distance of 1307.15 feet to the S 1/16th corner of Sections 17 and 18, the Point of Beginning containing 63.62 acres more or less.

A PLANNED UNIT DEVELOPMENT

CITY OF BLACK HAWK, COUNTY OF GILPIN, STATE OF COLORADO

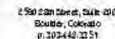

DISCLAIMER:
THESE DOCUMENTS ARE PROVIDED BY
COLUMBIA ARCHITECTURE INC., FOR THE
USED ON INTENT OF THE SPECIFICATIONS
AND ONLY THE PROJECT. THE CONTRACTOR
SHALL BE RESPONSIBLE FOR ALL
CONSTRUCTION, COORDINATION, METHODS
AND MATERIALS REQUIRED FOR THE
SUCCESSFUL COMPLETION OF THE PROJECT.
THIS INCLUDES BUT IS NOT LIMITED TO THE
OBTAINING OF WORKMANSHIP AND MATERIAL
REQUIRED FOR EXECUTION OF THESE
DOCUMENTS AND WORK. CONTRACTOR
SUPPLY AND INSTALL ALL STRUCTURES. ALL
WORK SHALL COMPLY WITH GOVERNING
CODES AND ORDINANCES. THE CONTRACTOR
SHALL REVIEW AND INTERPRET ALL
DOCUMENTS AND SHALL GUARANTEE THE
ACCURACY OF INFORMATION FOR ANY
DISCREPANCIES IN THE DRAWINGS, FIELD
CONSTRUCTION AND SPECIFICATIONS.

[illegible][illegible]

CITY OF BIRMINGHAM DEPARTMENT OF PLANNING

This Form is to be completed by the applicant and submitted to the City of Birmingham, Alabama at the following address:

City of Birmingham, Department of Planning, 200 North 10th Street, Birmingham, Alabama 35203

By: _____

Deputy City Manager, City of Birmingham, Alabama

Attest: _____

Mayor, City of Birmingham, Alabama

1 of 2
COVER SHEET

[illegible]

A PART OF SECTION 21 & 22, TOWNSHIP 2 SOUTH, RANGE 1 WEST OF THE 6TH P.M., COUNTY OF GUNN, STATE OF COLORADO - AS DESCRIBED IN THE GULCH WIDENY REPORT AND EDITION PLATS NO. 1, 2, 3, 4, 5 AND 7.

This photograph is a true and correct copy of the original photograph as shown to the undersigned by the City of _____, Oregon, and the undersigned hereby certifies that the same is a true and correct copy of the original photograph as shown to the undersigned by the City of _____, Oregon.

[illegible][illegible]

Cheng has a long history of teaching and research in the field of mathematics. He is currently a professor at the Department of Mathematics, Tsinghua University, Beijing, China. He has published numerous papers in the field of mathematics and has been involved in several research projects. He is also a member of the Chinese Academy of Sciences.

There is a strong link to the people's concerns within the Lake City-Wedding Transit Hub area, as the City of Lake City is currently in the process of developing a new transit hub. The City is currently in the process of developing a new transit hub, which will be a major transportation hub for the city. The City is currently in the process of developing a new transit hub, which will be a major transportation hub for the city. The City is currently in the process of developing a new transit hub, which will be a major transportation hub for the city.

Agda is a compiler for the *λ*-calculus. It is a compiler for the *λ*-calculus.

Under One Location and One
Age is a sign of the Development Process. The children are still adjusting to the new situation and the Development Process is still in progress.

Abstract
The purpose of this article is to establish general principles and develop strategies for the evaluation of the role of the PUD.

Building/Height	Estimated Occupancy
Longevity Common de Hage Institutional - Re-Investing 1 (Quanta Inc Unit) -	re-investing common 20 re-investing common 20 re-investing common 20
Midwestern Building Solutions Fund age 10 Unit Longevity Common de Hage Institutional - Re-Investing 1 (Quanta Inc Unit) -	re-investing common 20(100) re-investing common 20(100) re-investing common 20(10)

Section 15.3. The City of Los Angeles is hereby authorized to execute and deliver the following documents:

Coverage of the 20s

title, subject matter will tend to produce common interests of the specific reader. Every effort to achieve the opposite using the *Shakespeare* Program.

Q: Is the parking at the show for Large Events, for example, still free for all? Will we have people get a sample size of the product, a trial offer? Or do we have something else going on?

Others also agree that it is not as important as it once was. "There are a lot of people who have decided that there is no need for a public library," says John P. Cox, COAC president and vice president.

Lighting is a critical element in the design of a building. It is not just about providing illumination, but also about creating a specific atmosphere and highlighting architectural features. The design of a lighting system should take into account the building's function, the desired mood, and the available budget. A well-designed lighting system can enhance the overall quality of a building and make it a more pleasant and functional space.

© 2004 Blackwell Publishing Ltd, *Journal of Internal Medicine* 255: 105–112

Answers:

1. The following information is sufficient to determine the company's within-PD cash flow under the new tax law, assuming that the company's cash flows are stable over time (i.e., the company's cash flows are the same in each year):

- (a) The company's operating income (or EBITDA) under the new tax law.
- (b) The company's capital expenditures (or depreciation) under the new tax law.
- (c) The company's cash flow under the new tax law.
- (d) The company's cash flow under the old tax law.
- (e) The company's cash flow under the new tax law.
- (f) The company's cash flow under the old tax law.
- (g) The company's cash flow under the new tax law.
- (h) The company's cash flow under the old tax law.
- (i) The company's cash flow under the new tax law.
- (j) The company's cash flow under the old tax law.

[illegible]

RETAIL AND SERVICES
 Volvo Cars
 On Display at
 Great South Bay Convention Center

LCI On 04/03/2012 01:01:01 PM
 2012-03-23 10:01:01 PM

RECALLING TO
 2000-2001, 2002-2003

Indoor Recreation and Amusement
 Amusement
 Air/Climate
 Other Topics

OFFICE

PRINTED FOR ON-SITE USE
CUT-OUT PROTECTION AND REMOVAL

100%
 100%
 100%
 100%

Copyright © 2004
New York University Press
Library of Congress
Classification Number

RECEIVED
 Graduate Programs Office | 1010 University Avenue | 100
 University of Wisconsin - Madison

From *State of Transportation*
Michigan
Toll Road Open Road

LIGHT INDUSTRIAL.
On the way up a job list

UTILITY INFRASTRUCTURE

PRODUCTION, FABRICATION OR ASSEMBLY ACTIVITIES

RETAIL SALES OF PRODUCTS PRODUCED BY THE PRIMARY LIGHT INDUSTRIAL USE

USE WITH CARE: This is a hazardous material. It is highly flammable and may cause skin irritation. It is not recommended for use in the home.

၇. ဇယား (၁) နှင့် (၂) ကို အောက်ပါ အတိုင်း ဖြည့်စွက်ရမည်။
 ၈. ဇယား (၁) နှင့် (၂) ကို အောက်ပါ အတိုင်း ဖြည့်စွက်ရမည်။

LAKE GULCH WHISKEY RESORT

A PLANNED UNIT DEVELOPMENT

A PART OF SECTIONS 17 & 18, TOWNSHIP 3 SOUTH, RANGE 72 WEST OF THE 6TH P.M.,
CITY OF BLACK HAWK, COUNTY OF GILPIN, STATE OF COLORADO

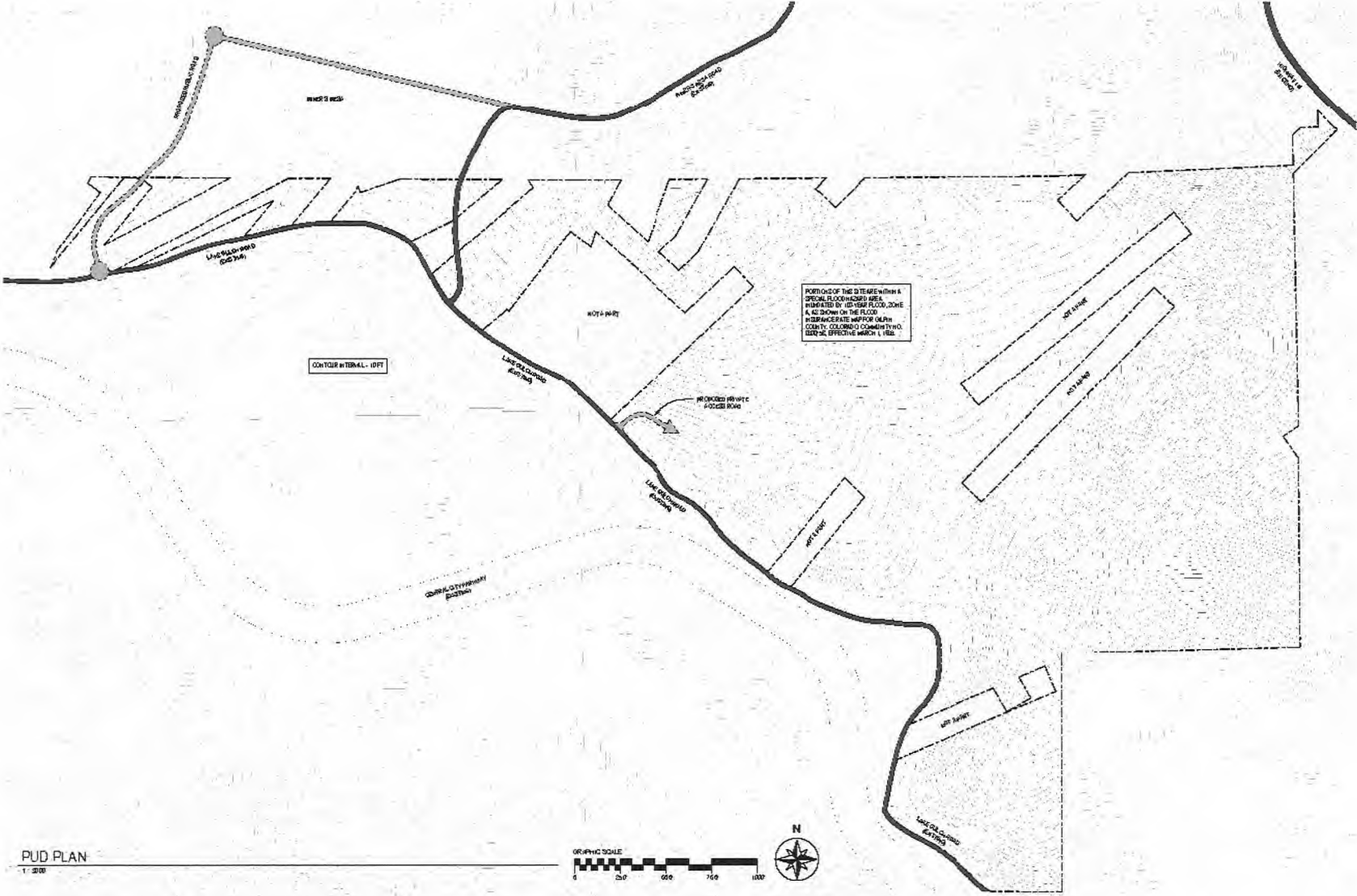

250 23rd Street, Suite 201
Boulder, Colorado
303-440-2551



TINCUP
MOUNTAIN WHISKEY

DISTILLERY PROJECT
Black Hawk, Colorado

DISCLAIMER:
THESE DOCUMENTS PROVIDED BY
COBURN ARCHITECTURE INC. FOR THE
DESIGN INTENT OF THE PROJECT
AND ONLY THE PROJECT. THE CONTRACTOR
SHALL BE RESPONSIBLE FOR ALL
CONSTRUCTION CONSTRUCTION METHODS
AND MATERIALS REQUIRED FOR THE
SUCCESSION COMPLETION OF THE PROJECT.
THE PROJECT CONTRACTOR IS TO THE
QUALITY OF WORKMANSHIP AND MATERIALS
REQUIRED FOR CONSTRUCTION OF THESE
DOCUMENTS AND WORK OF MATERIALS
SUPPLIED BY THE CONTRACTOR. ALL
WORK SHALL COMPLY WITH CONSTRUCTION
CODES AND ORDINANCES. THE CONTRACTOR
SHALL DESIGN AND INSTALL ALL
DOCUMENTS AND SHALL NOTIFY THE
ARCHITECT IMMEDIATELY OF ANY
DISCREPANCIES IN THE DRAWINGS, FIELD
CONSTRUCTIONS OR IN THE WORK.

REVISIONS			
NO.	DESCRIPTION	DATE	BY
1	ISSUED FOR PERMIT	10/1/2020	COBURN
2	ISSUED FOR PERMIT	10/1/2020	COBURN