



Rental - Sales - Service  
Traffic Control - Sign Manufacturing & Installation  
Pavement Marking - Contractor Supplies

Traffic Control Division  
2295 South Lipan St.,  
Denver, CO 80223  
D: (303) 922-7815  
F: (303) 922-5433

**TRAFFIC CONTROL PLAN**

Plan For: RMS Cranes  
Address: 101 Main St  
Blackhawk, CO 80422  
FM: Tom Lewis 303.887.2451  
Date: 08.04.2017  
Plan By: Jim Sellers  
PO/Job: TBD

**MHT #1**

NOT DRAWN TO SCALE

All devices conform to  
the current MUTCD  
and M-S Standards.

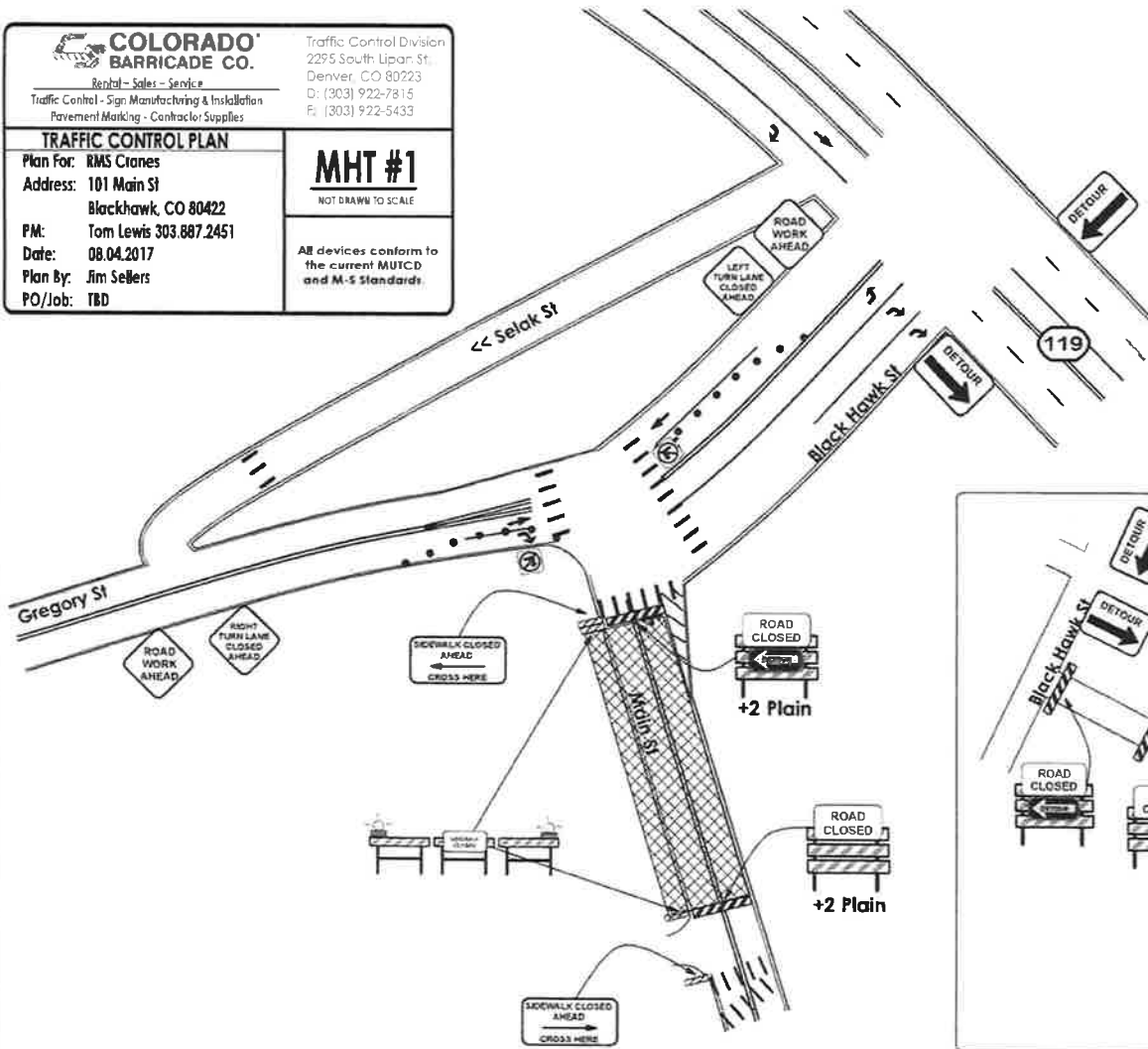

**Summary of Devices:**

- 4 - 48" Road Work Ahead
- 1 - 48" Road Closed Ahead
- 1 - 48" Detour Ahead
- 1 - 48" Right Turn Lane Closed Ahead
- 1 - 48" Left Turn Lane Closed Ahead
- 1 - T-III Road Closed TTT Det R
- 1 - T-III Road Closed Def L
- 1 - T-III Road Closed
- 4 - T-III Plain
- 2 - Ped Crossover 1R 1L
- 2 - T-I Sidewalk Closed
- 4 - T-I Plain
- 1 - No Right Turn
- 1 - No Left Turn
- 2 - Detour Left
- 2 - Detour Right
- 12 - 36" Cones

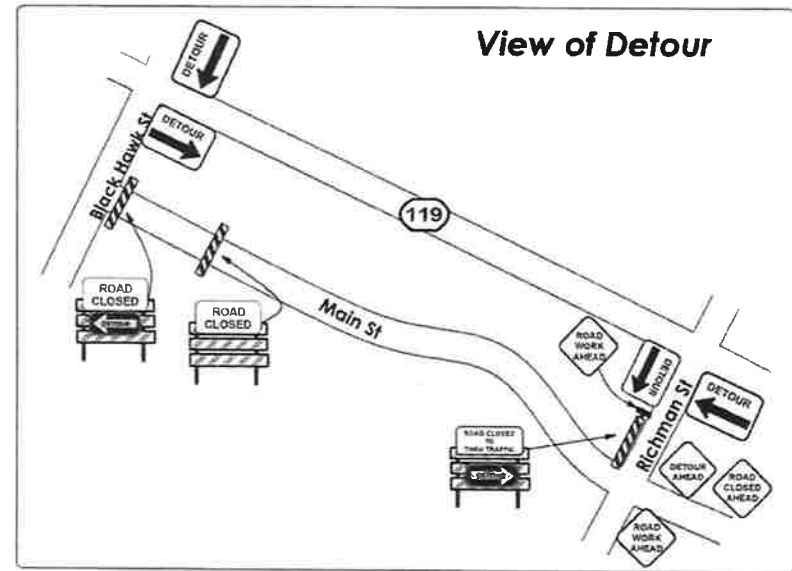

**View of Detour**